

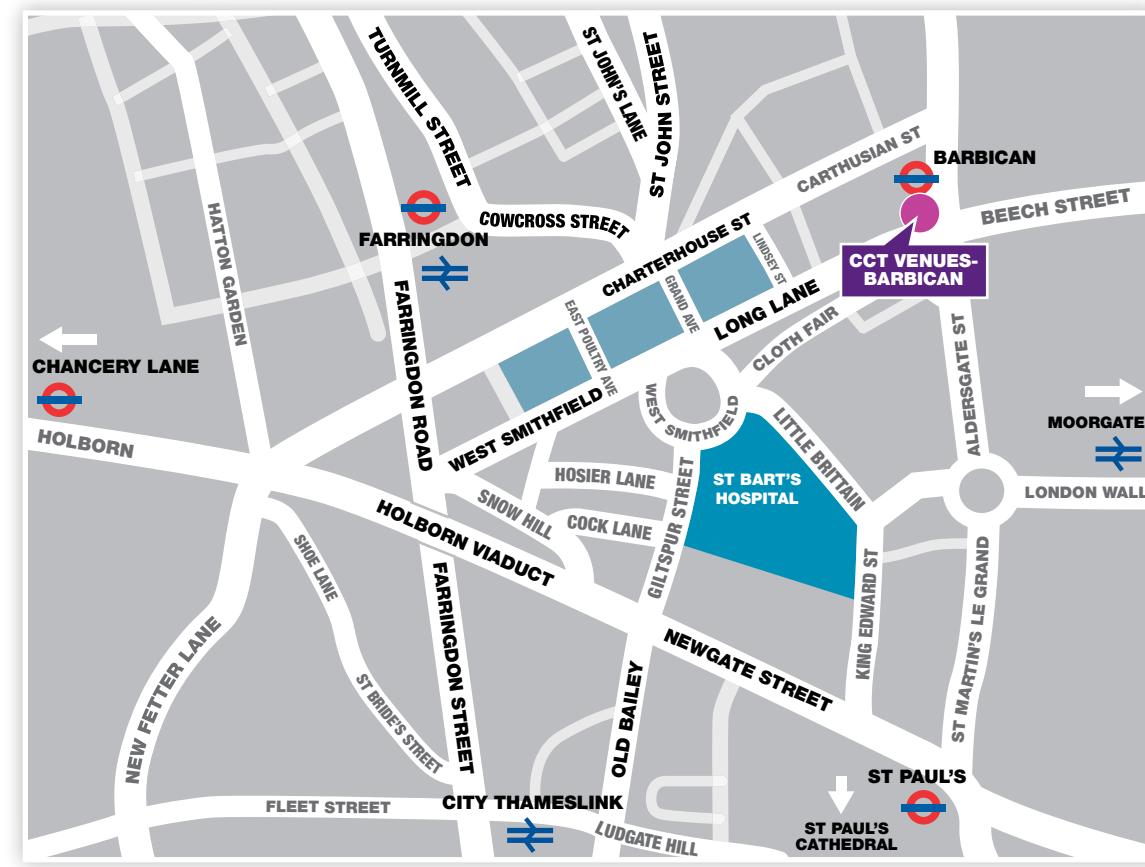

CCT Venues-Barbican, a professional environment in a convenient City location



CCT Venues-Barbican
Aldersgate House, 135-137 Aldersgate Street, London, EC1A 4JA

For booking and enquiries:
T: 0808 168 1168
E: enquire@cctvenues.co.uk



cctvenues.co.uk



Experts in Event Space

cctvenues.co.uk

CCT Venues-Barbican Experts in Event Space

Refurbished and modernised in 2016, CCT Venues-Barbican offers a professional environment in a superbly convenient City location. The venue occupies the whole of Aldersgate House, on the corner of Aldersgate Street and Long Lane, in London EC1. The 20 training and meeting rooms are arranged over five floors and offer a range of bright, airy spaces, with large windows and individually controlled air conditioning.

CCT Venues-Barbican has a great mix of room sizes, with capacity for groups of 4 to 150. The venue has a strong reputation for superb service and expert management of training events.

In addition to great rooms, the venue also has a modern top floor Sun Restaurant, with capacity for over 140 and offering a range of freshly prepared food from our in-house chefs. All other floors have refreshment areas with tea and coffee facilities.

All rooms are well equipped with modern furniture, quality audio visual equipment and powerful data links. Events are supported by our first class, highly experienced team who put warm, professional service central to everything.

You'll find the venue directly next to Barbican underground station and only a few minutes' walk from CCT Venues-Farringdon and CCT Venues-Smithfield. City Thameslink mainline, Farringdon, St Paul's and Moorgate tube stations are also just a short walk away.

CCT Venues also have locations in Canary Wharf, offering great choice across London's busiest business districts.

Rooms	Size and location	Minimum numbers	Maximum Theatre style	Maximum Classroom style	Maximum Round Cabaret style (tables of 6)	Maximum Square Cabaret style (tables of 6)	Maximum U Shape style	Maximum Board style
Jupiter/Saturn	20.5 x 7.8m Third floor	70	150	100	90	72	52	60
Jupiter	10.1 x 7.8m Third floor	35	70	46	36	30	28	36
Saturn	10.1 x 7.8m Third floor	35	70	46	36	30	28	36
Neptune/Pluto	18.6 x 5.8m Third floor	50	100	78	66	54	52	56
Neptune	14.5 x 5.8m Third floor	38	80	62	54	42	40	44
Pluto	4.1 x 5.8m Third floor	8	18	12	12	-	10	12
Xena	12.4 x 7.8m Ground floor	40	90	66	54	42	34	40
Discovery	14.8 x 7.8m Second floor	46	120	72	60	48	40	44
Apollo/Voyager	9.5 x 7.8m Second floor	30	90	46	36	36	22	32
Apollo	4.9 x 7.8m Second floor	16	40	28	24	18	18	22
Voyager	4.9 x 7.8m Second floor	16	40	28	24	18	18	22
Polaris	9.5 x 5.6m First floor	22	56	30	30	24	20	24
Electra	8.0 x 6.3m First floor	18	50	30	30	24	22	24
Uranus	7.8 x 5.1m Third floor	16	40	28	24	18	18	22
Atlantis	9.5 x 5.8m Second floor	16	64	40	36	36	24	30
Regulas	6.3 x 4.8m First floor	8	20	12	-	-	12	12
Eris	5.7 x 5.7m First floor	10	35	16	15	12	14	16
Venus	7.6 x 4.6m Fourth floor	14	40	24	24	12	16	20
Luna	5.8 x 4.9m Second floor	8	20	14	18	12	10	16
Earth	5.4 x 4.9m Fourth floor	8	21	14	18	12	12	16
Mars	5.4 x 4.9m Fourth floor	8	21	14	18	12	12	16
Vega	5.1 x 5.1m First floor	8	20	12	-	-	12	12
Rana	5.1 x 5.1m First floor	8	20	10	-	-	6	8
Sun Restaurant	118m ² Fourth floor	-	-	-	-	-	-	-

Ceiling height: 2.54m

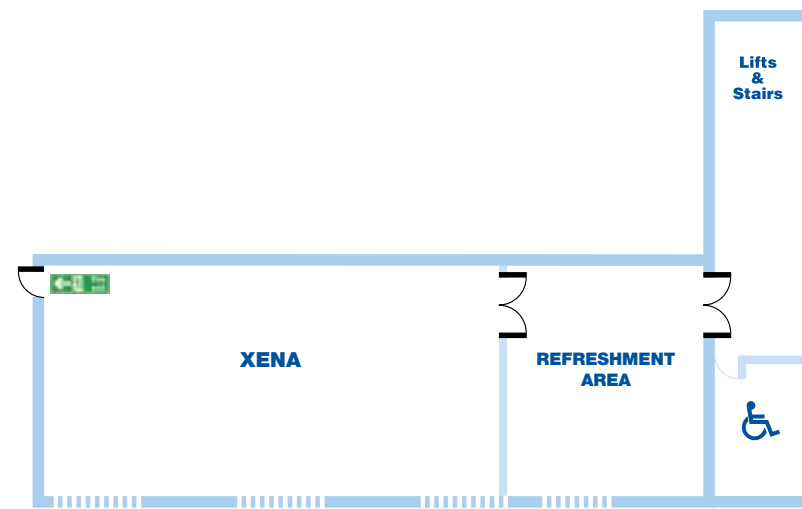

Ground Floor

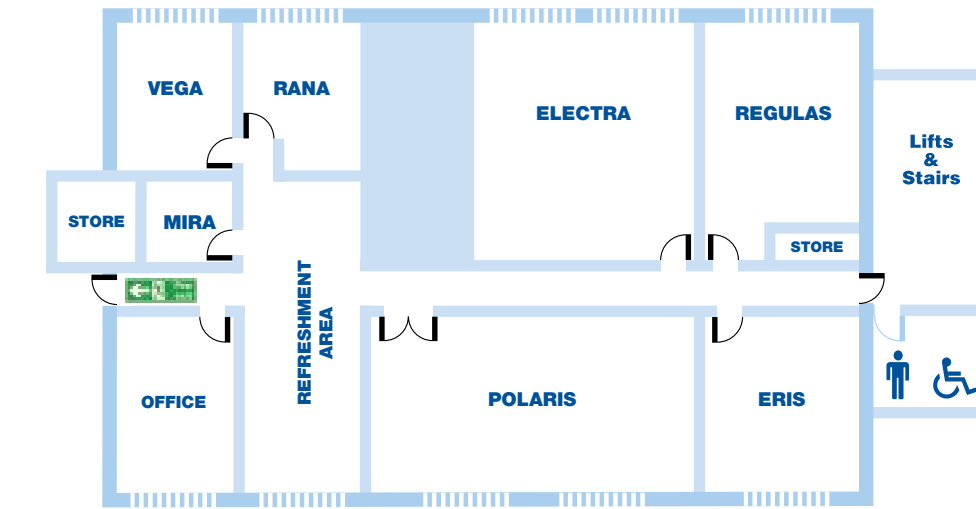

First Floor

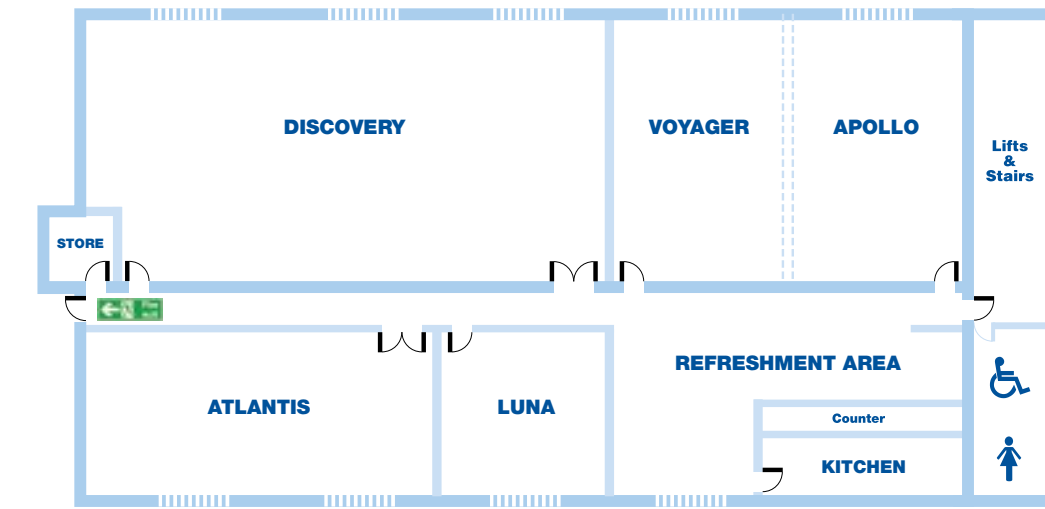

Second Floor

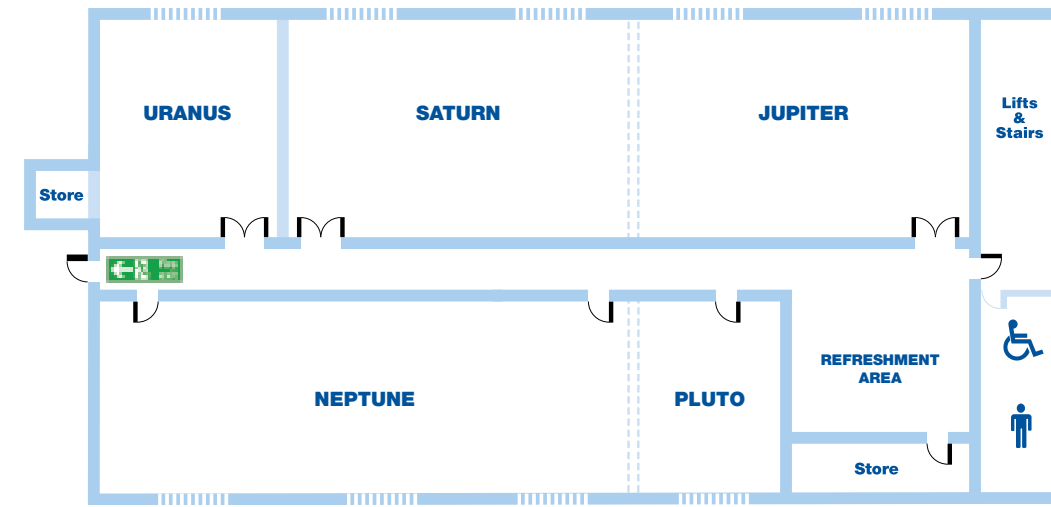

Third Floor

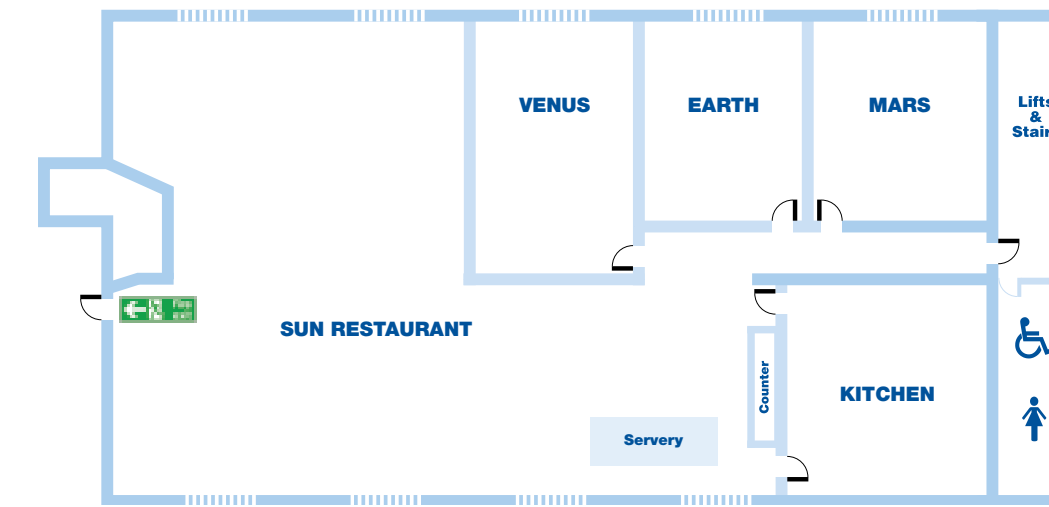

Fourth Floor



Electra

"Thank you so much for the wonderful organisation of our meeting. Everything was very smooth and we were all really impressed with the venue, facilities and food. The team took the stress out of the entire process."
London Council

"I am very happy with CCT Venues' whole service, which has been very friendly, helpful, efficient and easy to deal with. I would definitely recommend holding meetings here - everything ran smoothly and we were well looked after at the Barbican venue - there was a lovely choice of good food too!"
National Broadcaster



Atlantis



On-site Catering



Discovery



Luna



Restaurant