

# CCTvenues

PLUS

## CCT Venues Plus-Bank Street



Experts in Event Space

Rooms	Size	Minimum numbers	Maximum Theatre style	Maximum Cabaret style (tables of 8)	Maximum U Shape style	Maximum Boardroom style	Maximum Hollow Square style	Maximum Classroom style	Maximum Banqueting style (tables of 10, approx)	Maximum Stand-up Reception style (approx)
<b>Level 32</b>										
Vista Suite*	25.5m x 8.5m	100	220	160	74	62	80	150	220	220
Room 6	8.5m x 6.0m	22	64	32	22	22	26	30	50	50
Room 7	8.5m x 6.0m	22	64	32	22	22	26	30	50	50
Room 8	8.5m x 6.0m	22	64	32	22	22	26	30	50	50
Room 9	8.5m x 7.5m	28	90	48	28	28	32	40	70	70
Room 6 & 7	12.0m x 8.5m	44	130	64	32	28	40	66	100	150
Room 7 & 8	12.0m x 8.5m	44	130	64	32	28	40	66	100	150
Room 8 & 9	13.5m x 8.5m	50	145	80	38	34	46	76	120	170
Room 6, 7 & 8	18.0m x 8.5m	66	190	96	44	40	52	100	150	220
Room 7, 8 & 9	19.5m x 8.5m	66	215	112	50	46	60	110	170	220
The View	12.0m x 9.5m	60	150	64	34	32	44	62	100	160
Room 11 & 12	12.0m x 5.5m	20	80	40	34	34	36	30	48	50
Room 11	6.0m x 5.5m	10	40	16	12	14	16	14	20	25
Room 12	6.0m x 5.5m	10	40	16	12	14	16	14	20	25
Room 13 & 14	12.0m x 5.5m	20	80	40	34	34	36	30	48	50
Room 13	6.0m x 5.5m	10	40	16	12	14	16	14	20	25
Room 14	6.0m x 5.5m	10	40	16	12	14	16	14	20	25
Room 5	9.4m x 7.8m	34	110	48	28	24	34	48	80	80
Room 10	8.0m x 6.0m	16	50	32	20	20	24	28	24	50
Room 3	8.5m x 5.5m	14	50	32	18	18	22	26	50	50
Room 1	6.0m x 5.5m	10	40	16	12	14	16	14	20	25
Room 2	6.0m x 5.5m	10	40	16	12	14	16	14	20	25
Boardroom 1	2.9m x 5.0m	6	-	-	-	8	-	-	-	-
Boardroom 2	2.9m x 6.3m	6	-	-	-	10	-	-	-	-
Select A**	4.5m x 3.0m	-	-	-	-	8	-	-	-	-
Select B**	4.5m x 3.0m	-	-	-	-	8	-	-	-	-
Select C**	4.8m x 4.0m	-	-	-	-	4	-	-	-	-
Select E**	4.5m x 1.7m	-	-	-	-	2	-	-	-	-
Select F**	4.5m x 1.7m	-	-	-	-	2	-	-	-	-
Select G**	2.5m x 4.3m	-	-	-	-	8	-	-	-	-
Executive Lounge	9.0m x 9.0m	-	-	-	-	-	-	-	60	80
Sunset Bar**	24.0m x 2.3m	-	-	-	-	-	-	-	-	60
Skyline Restaurant and Bar	21.5m x 12.0m	-	-	-	-	-	-	-	140	220
<b>Level 29</b>										
Elite 1, 2 & 3	24.5m x 8.9m	95	110	110	68	-	88	110	110	110
Elite 1 & 2	18.3m x 8.9m	75	110	96	56	-	70	96	110	110
Elite 2 & 3	12.1m x 8.9m	50	110	64	44	-	52	60	90	100
Elite 1	12.4m x 8.9m	50	110	72	34	-	44	66	100	110
Elite 2	5.9m x 8.9m	25	60	32	22	22	26	30	40	50
Elite 3	6.2m x 8.9m	25	60	32	22	22	26	30	40	50
Elite Lounge	15m x 9m	-	-	-	-	-	-	-	-	100

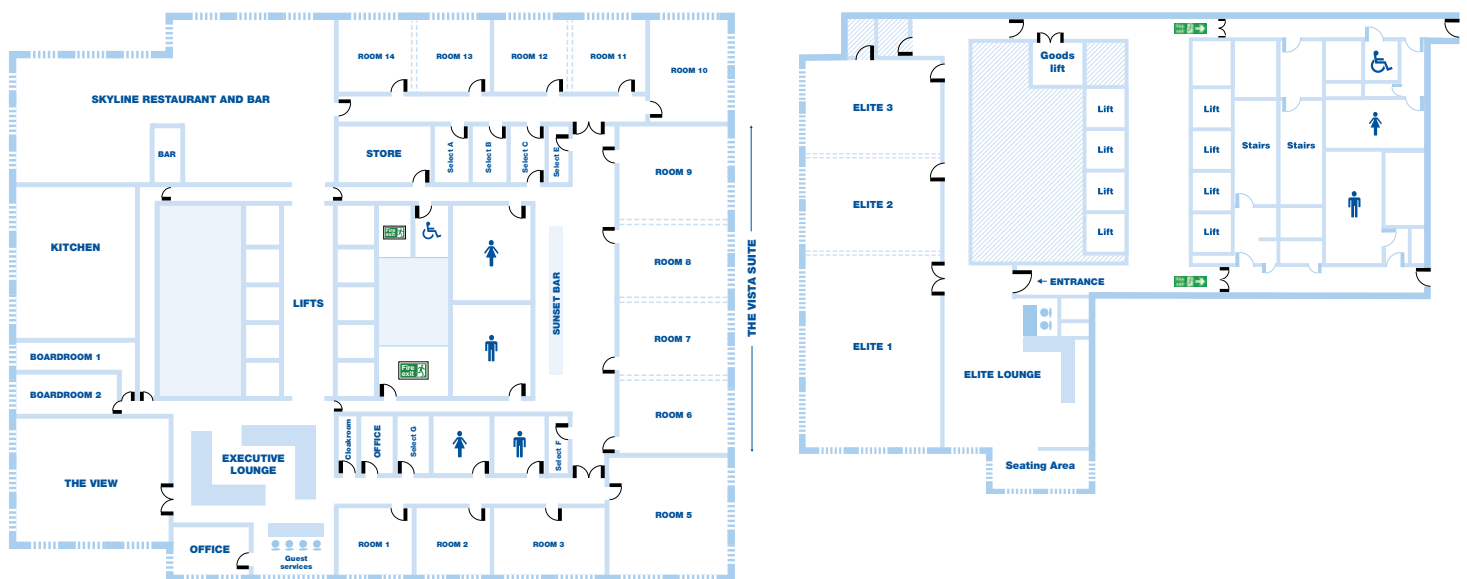

- Based in central Canary Wharf, minutes from the Underground station
- Fabulous London views from this 32nd floor penthouse venue
- 29 flexible meeting rooms to hire, accommodating between six and 220 delegates
- Ideal for meetings, training sessions, assessment centres, conferences and corporate hospitality events
- Private Elite Suite with city views ideal for a prestige event, senior business meeting or VIP conference

For bookings and enquiries:

**T: 0808 168 1168 E: [enquire@cctvenues.co.uk](mailto:enquire@cctvenues.co.uk)**

CCT Venues Plus-Bank Street, Canary Wharf, Level 32, 40 Bank Street, London, E14 5NR